

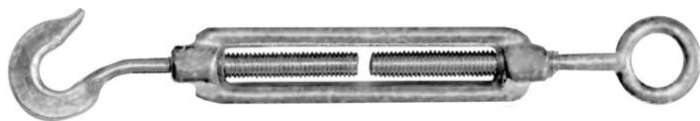

ЦИНКОВОЕ
ПОКРЫТИЕ
В БЕЛОМ ЦВЕТЕ

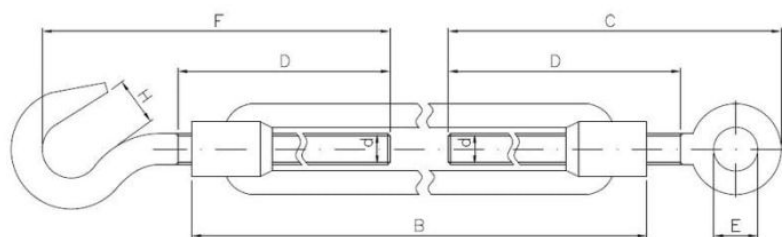

????????? (?????????):



????????

| Material index | d | B [mm] | C [mm] | F [mm] | D [mm] | H [mm] | E [mm] | Nośność na rozciąganie [kN] |
|----------------|-----|--------|--------|--------|--------|--------|--------|-----------------------------|
| 6308050070ATS | M5 | 70 | 57 | 56 | 35 | 7 | 8 | 1.31 |
| 6308060110ATS | M6 | 110 | 80 | 77 | 55 | 8 | 9 | 2.54 |
| 6308080110ATS | M8 | 110 | 85 | 89 | 57 | 10.5 | 10 | 4.94 |
| 6308100125ATS | M10 | 125 | 105 | 106 | 68 | 13 | 14 | 5.29 |
| 6308120125ATS | M12 | 125 | 111 | 117 | 70 | 16 | 16 | 8.29 |
| 6308140140ATS | M14 | 140 | 124 | 124 | 75 | 18 | 18 | 9.62 |
| 6308160170ATS | M16 | 170 | 150 | 144 | 88 | 20 | 22 | 17.22 |
| 6308180200ATS | M18 | 200 | 160 | 163 | 98 | 21 | 25 | 17.24 |
| 6308200200ATS | M20 | 200 | 168 | 170 | 105 | 21 | 25 | 26.29 |
| 6308220220ATS | M22 | 220 | 190 | 200 | 118 | 24 | 28 | 28.62 |
| 6308240255ATS | M24 | 255 | 215 | 210 | 135 | 26 | 28 | 29.51 |
| 6308270255ATS | M27 | 255 | 224 | 240 | 135 | 34 | 31 | 29.86 |
| 6308300255ATS | M30 | 255 | 224 | 240 | 135 | 34 | 31 | 43.60 |